

1143 Sheridan Avenue.
Cody, WY 82414
Telephone: (307) 587-5584
Toll Free: (800) 538-5122
Fax: (307) 587-5553
Email: info@westernre.net



Fiddle Back Parcel 2

Listing Agent: Brian D. Webster, Associate Broker
brianwebster@westernre.net, 307-899-2494

Price: \$925,000

Address: 2 Road 4EU, Meeteetse WY 82433

MLS Number: 10004335

Description: Exceptional home sites on 108.67± acres with nearly 1/2 mile of Greybull river frontage. Stellar views of the river valley, mountains and rugged sandstone formations. Center pivot sprinkler irrigates 57.3± acres. River bottom and meadows offer excellent wildlife habitat. Property is above release point for Lower Sunshine Reservoir so summer fishing is excellent. Final acreage TBD by survey.

Square Feet:

Land Area: 108.67± acres

Bedrooms:

Bathrooms:



This map may be inaccurate for new or remote addresses. Please double check the location before using this information.



T.48 N., R.101 W. (RESURVEY)

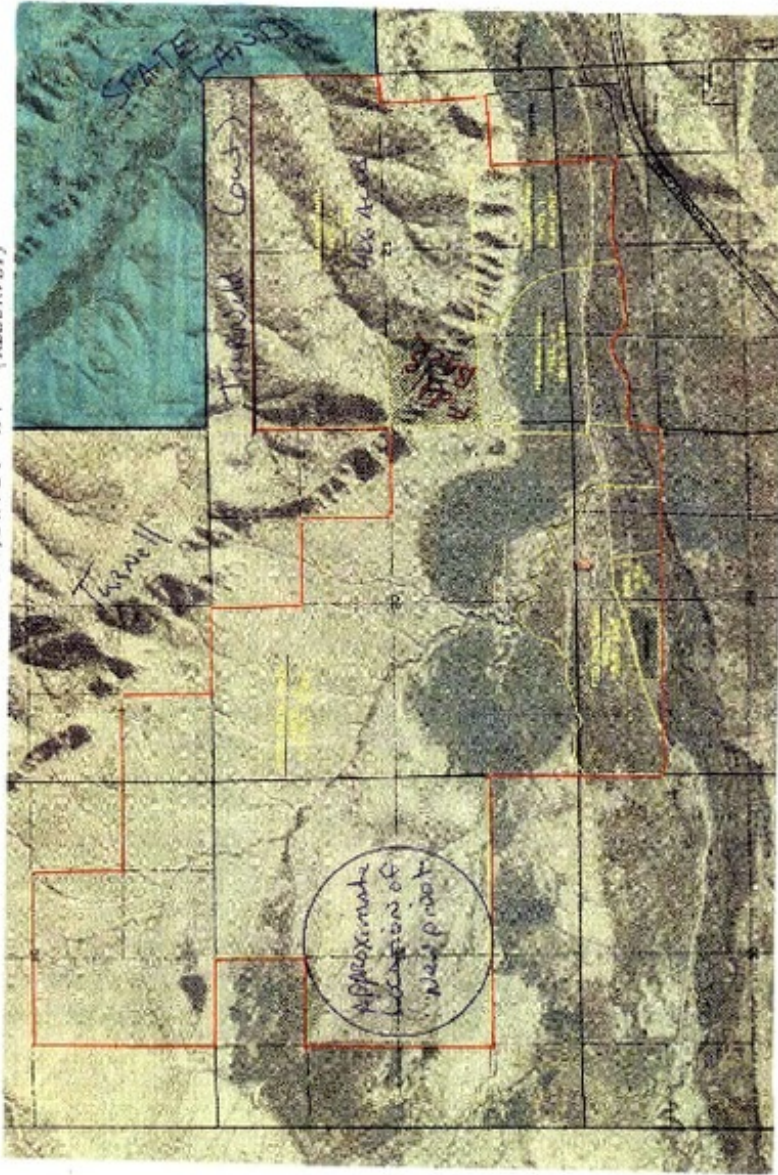

FIDDLEBACK OWNERSHIP
IN PARTS OF
SECTION 15, 20, 21, 24 & 25 T.48 N., R.101 W.
DADE COUNTY, FLORIDA

PROPOSED PARCELS ABSTRACT
AND BOUNDARY SURVEY TO
CHARGE WITH THE NATIONAL
MOVEMENT OF THE SILVER

SCALE TO THE SURVEYING INSTRUMENTS USED IN THE SURVEY
PLANNED TO BE USED IN THE SURVEY

00000000

00000000

00000000

00000000

00000000

00000000

00000000

00000000

00000000

00000000

00000000

00000000

00000000